



vista

seaford heights



Grandview 2 contour plans

ALLOTMENT 554 in DEV. NO. 145/D215/12/011
 in the area named
SEAFORD HEIGHTS

CT ---/---

AS CONSTRUCTED

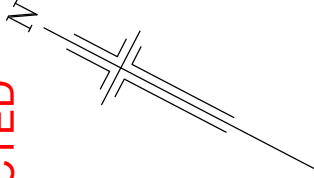

WATERCOLOUR ROAD

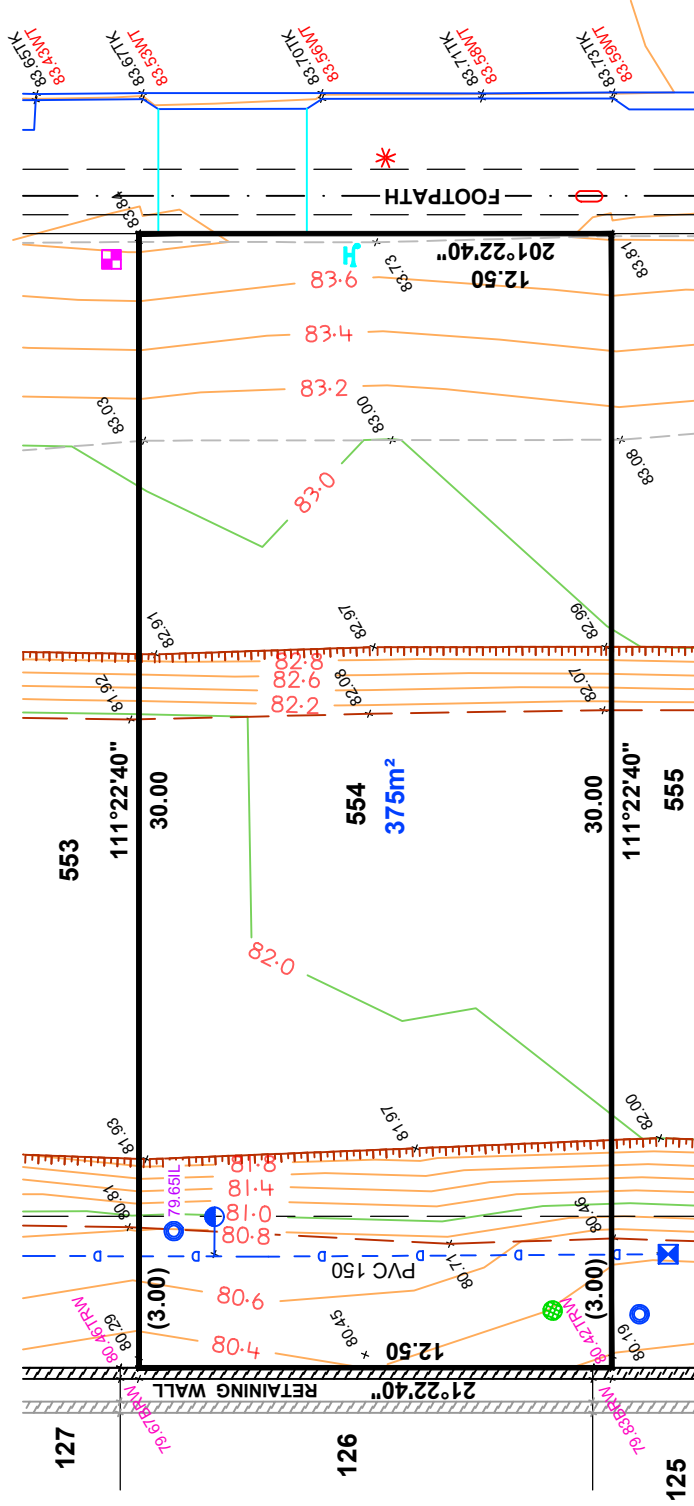

LEGEND

- WATER METER
- SEWER IP
- STOBIE POLE
- TELSTRA PIT
- S/W GRATING
- SEWER MAN HOLE
- S/W MANHOLE
- LIGHT POLE
- E.T.S.A CONNECTION
- TAP
- BOLLARD
- SIGN
- S/W CONNECTION
- FOOTPATH
- SIDE ENTRY PIT
- COMMON SERVICE TRENCH
- DOMESTIC
- SEWER IO
- POTABLE WATER CONN
- NON-POTABLE WATER CONN
- TOP RETAINING WALL



1:200

NOTE: FOOTPATH & CST DATA SHOWN HEREON IS DESIGN INFORMATION AND SHOULD BE CONFIRMED.

ORIGINAL SHEET SIZE A4

DISCLAIMER:
 Please note that this site plan is intended for visual purposes only, additional survey work will be required prior to commencing any design or construction on the site.

IMPORTANT
 SERVICE AND DRIVEWAY LOCATIONS ARE APPROXIMATE. ANY CHANGES WILL BE AT THE PURCHASERS EXPENSE.
 PURCHASER: _____
 PURCHASER: _____
 DATE: _____

ALLOTMENT 555 in DEV. NO. 145/D215/12/008

in the area named
SEAFORD HEIGHTS

PRELIMINARY

CT .../....

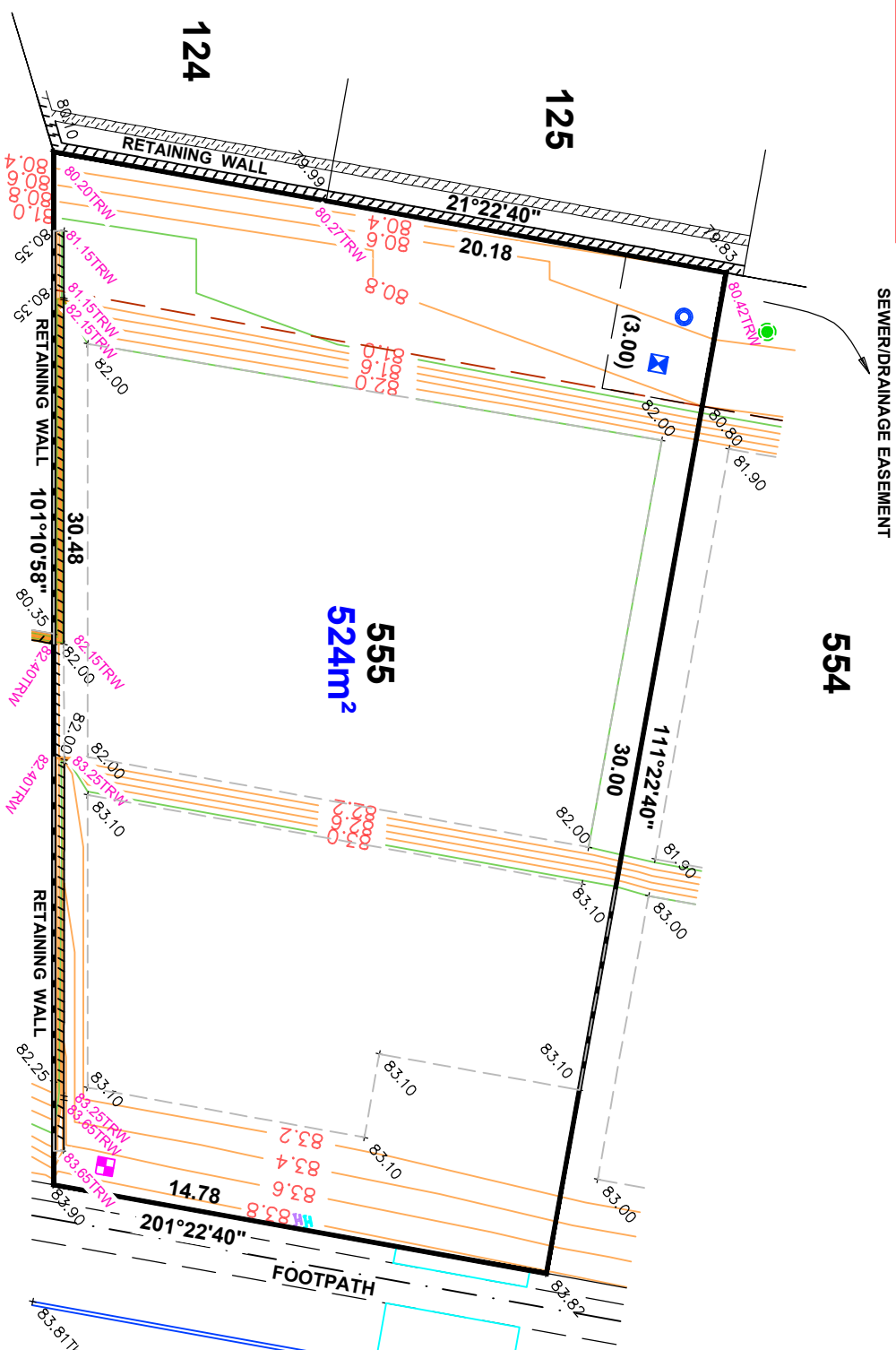

WATERCOLOUR ROAD

LEGEND

| | |
|--|------------------------|
| | WATER METER |
| | SEWER IP |
| | STOBIE POLE |
| | TELSTRA PIT |
| | S/W GRATING |
| | SEWER MAN HOLE |
| | S/W MANHOLE |
| | LIGHT POLE |
| | ETSA CONNECTION |
| | TAP |
| | BOLLARD |
| | SIGN |
| | S/W CONNECTION |
| | FOOTPATH |
| | SIDE ENTRY PIT |
| | COMMON SERVICE TRENCH |
| | DOMESTIC |
| | SEWER IO |
| | POTABLE WATER CONN |
| | NON-POTABLE WATER CONN |
| | TOP RETAINING WALL |

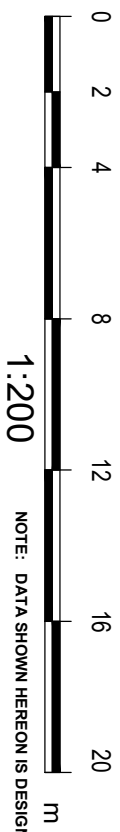

NOTE: DATA SHOWN HEREON IS DESIGN INFORMATION AND SHOULD BE CONFIRMED

ORIGINAL SHEET SIZE A4

DISCLAIMER:
 Please note that this site plan is intended for visual purposes only, additional survey work will be required prior to commencing any design or construction on the site.

ALLOTMENT 556 in DEV. NO. 145/D215/12/008

in the area named
SEAFORD HEIGHTS

CT ---/----

PRELIMINARY

IMPORTANT
SERVICE AND DRIVEWAY LOCATIONS
ARE APPROXIMATE. ANY CHANGES WILL
BE AT THE PURCHASERS EXPENSE.
PURCHASER: _____
PURCHASER: _____
DATE: _____

DISCLAIMER:

Please note that this site plan is intended for
visual purposes only, additional survey work will
be required prior to commencing any design or
construction on the site.

555

121

556
496m²

WATERCOLOUR ROAD

EVERTON ROAD

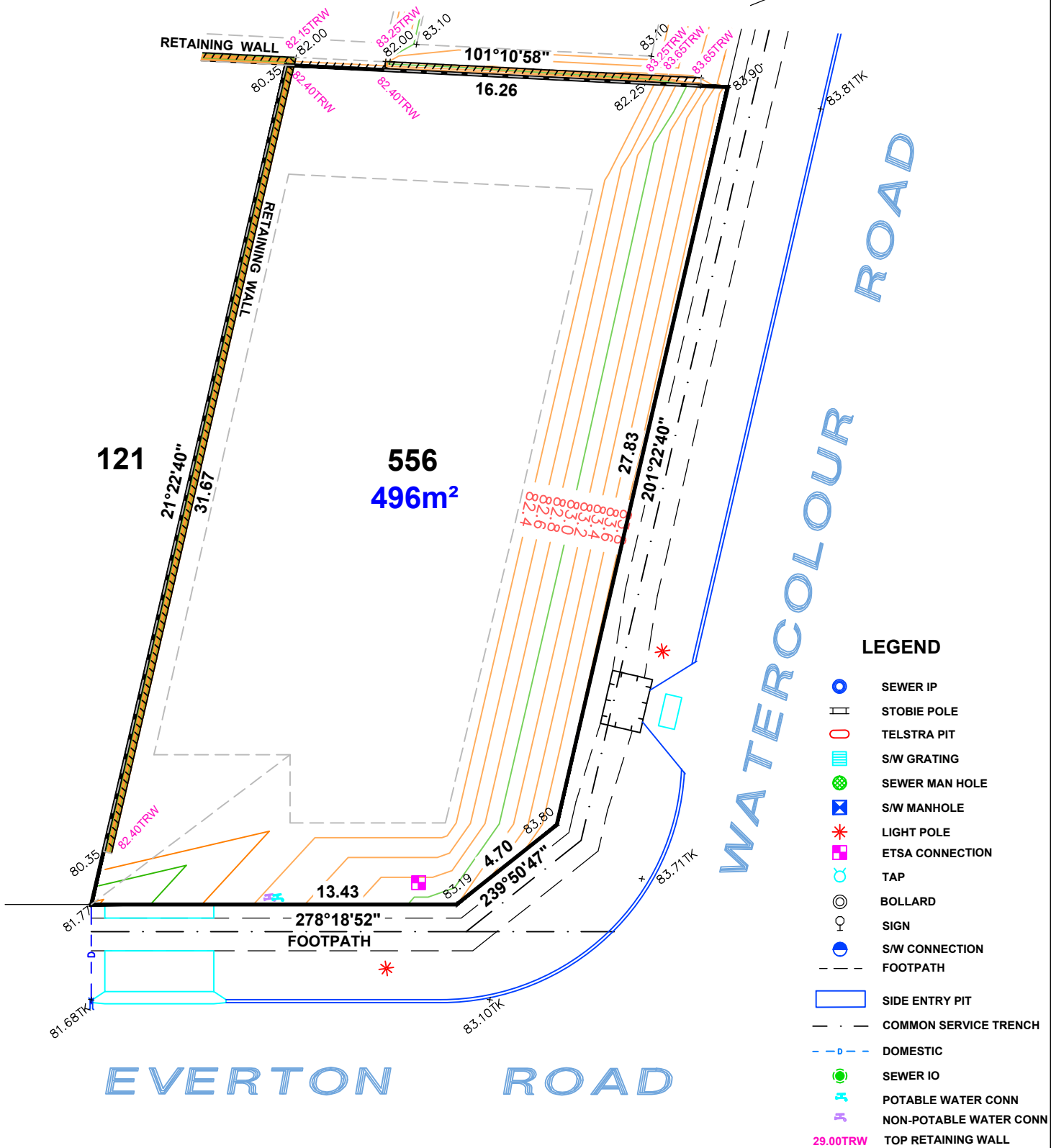

LEGEND

- SEWER IP
- STOBIE POLE
- TELSTRA PIT
- S/W GRATING
- SEWER MAN HOLE
- S/W MANHOLE
- LIGHT POLE
- ETSA CONNECTION
- TAP
- BOLLARD
- SIGN
- S/W CONNECTION
- FOOTPATH
- SIDE ENTRY PIT
- COMMON SERVICE TRENCH
- DOMESTIC
- SEWER IO
- POTABLE WATER CONN
- NON-POTABLE WATER CONN
- 29.00TRW TOP RETAINING WALL

NOTE: DATA SHOWN HEREON IS DESIGN INFORMATION
AND SHOULD BE CONFIRMED.



1:200

ALEXANDER SYMONDS
PH 8130 1666

ORIGINAL SHEET SIZE A4

DISCLAIMER:

Please note that this site plan is intended for visual purposes only, additional survey work will be required prior to commencing any design or construction on the site.

ALLOTMENT 557 in DEV. NO. 145/D215/12/011

**in the area named
SEAFORD HEIGHTS**

CT ---/----

AS CONSTRUCTED

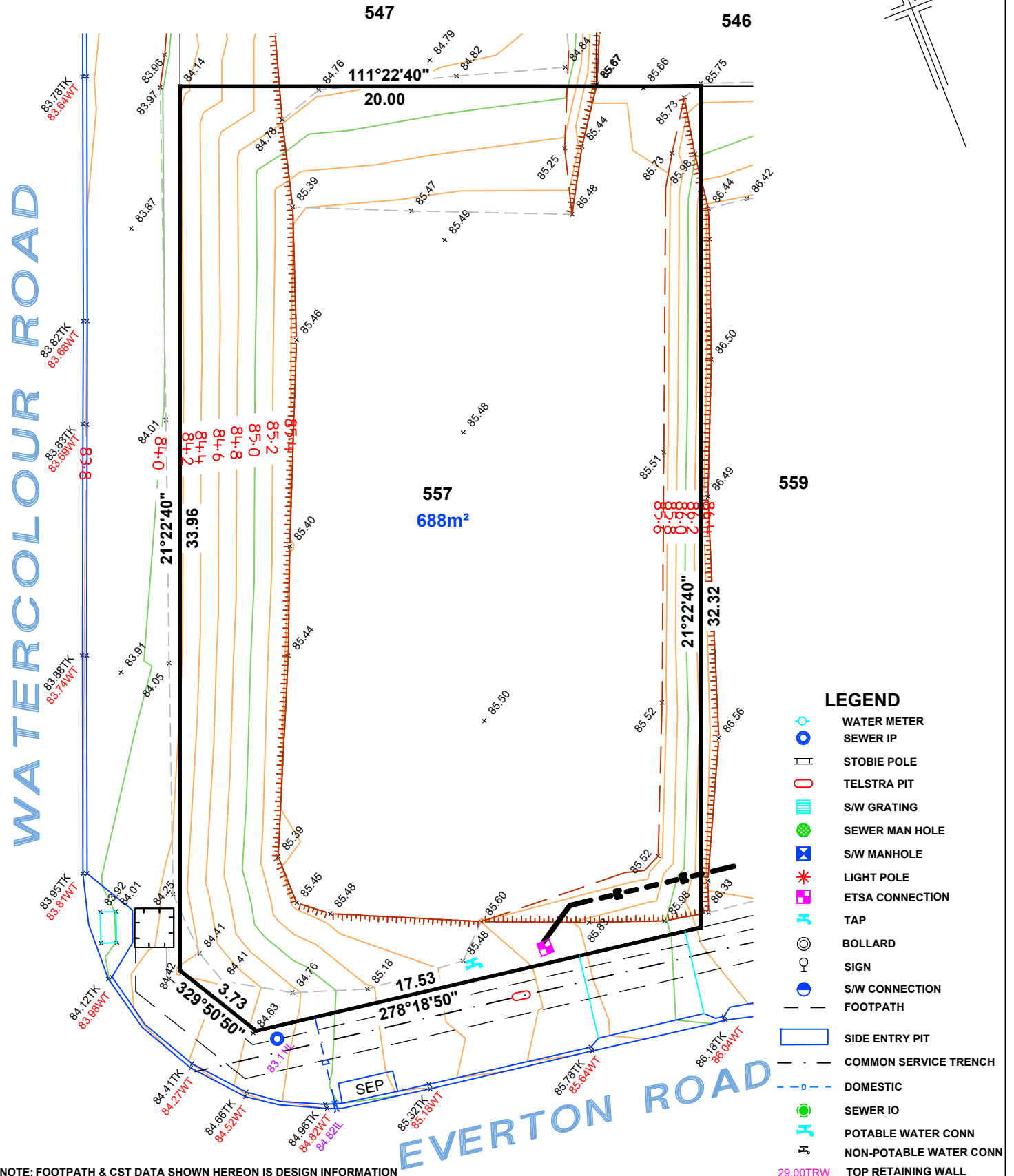
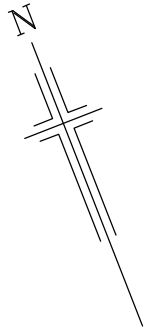

DISCLAIMER:

Please note that this site plan is intended for visual purposes only, additional survey work will be required prior to commencing any design or construction on the site.

ALLOTMENT 559 in DEV. NO. 145/D215/12/011

**in the area named
SEAFORD HEIGHTS**

CT ---/----

AS CONSTRUCTED

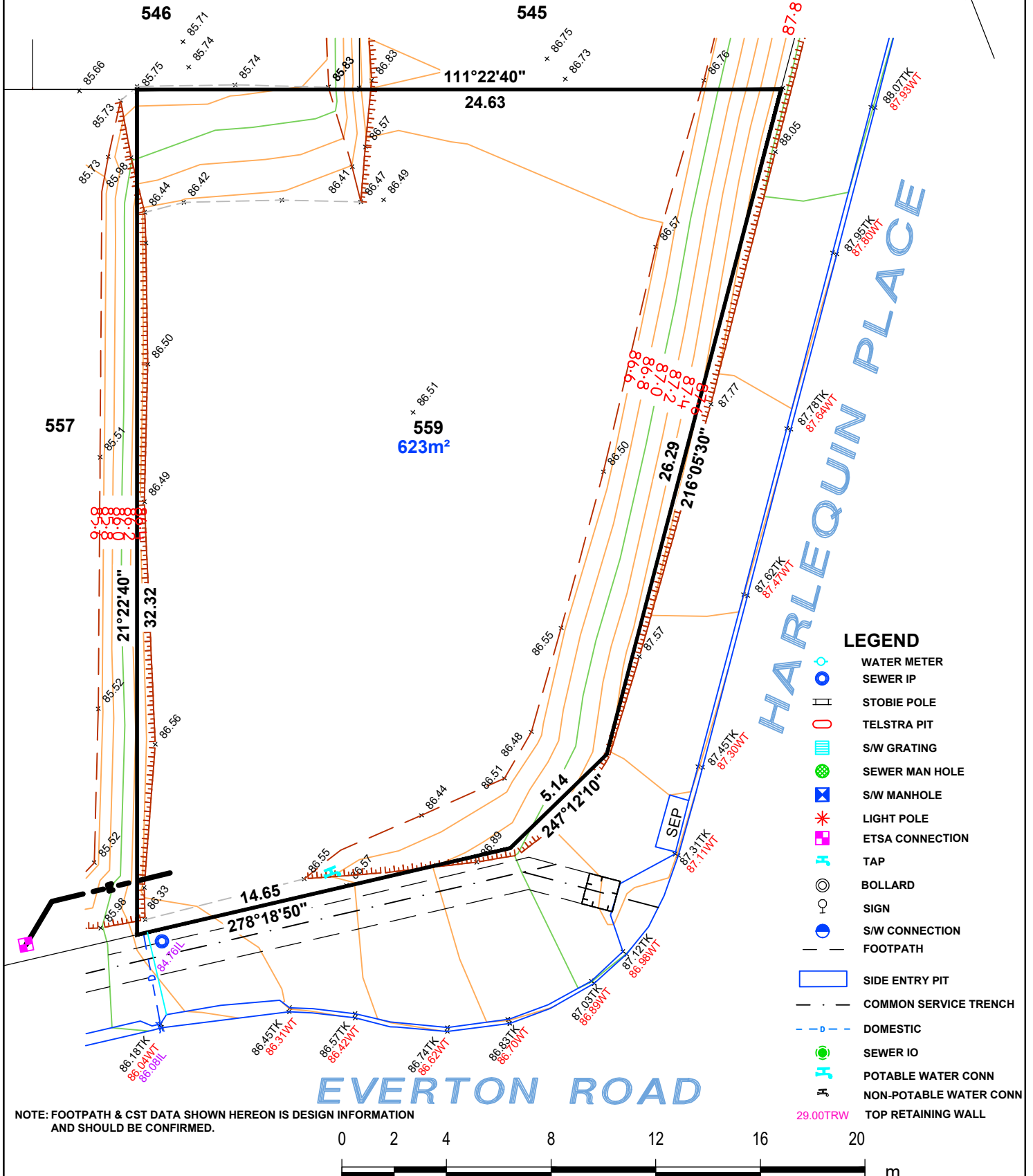
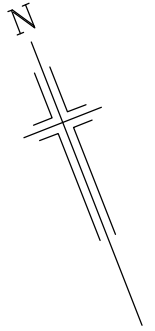

LEGEND

- WATER METER
- SEWER IP
- STOBIE POLE
- TELSTRA PIT
- ▒ S/W GRATING
- SEWER MAN HOLE
- ▒ S/W MANHOLE
- ★ LIGHT POLE
- ETSA CONNECTION
- ⋈ TAP
- BOLLARD
- SIGN
- S/W CONNECTION
- FOOTPATH
- SIDE ENTRY PIT
- COMMON SERVICE TRENCH
- DOMESTIC
- SEWER IO
- ⋈ POTABLE WATER CONN
- ⋈ NON-POTABLE WATER CONN
- 29.00TRW TOP RETAINING WALL

NOTE: FOOTPATH & CST DATA SHOWN HEREON IS DESIGN INFORMATION AND SHOULD BE CONFIRMED.

ALEXANDER SYMONDS
PH 8130 1666

ORIGINAL SHEET SIZE A4

IMPORTANT
 SERVICE AND DRIVEWAY LOCATIONS ARE APPROXIMATE. ANY CHANGES WILL BE AT THE PURCHASERS EXPENSE.
 PURCHASER: _____
 PURCHASER: _____
 DATE: _____

COTTERELL ROAD

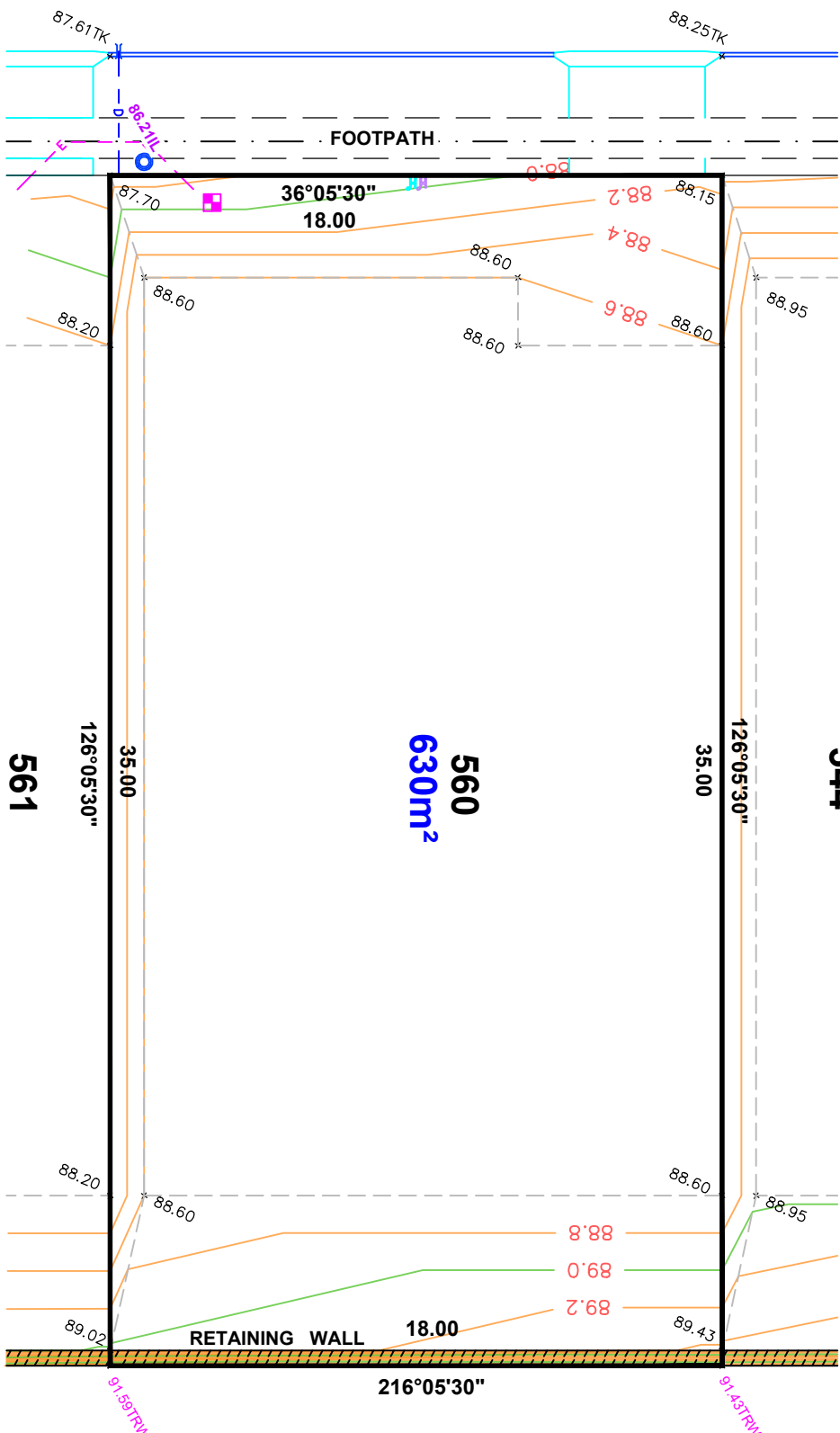

ALLOTMENT 560 in DEV. NO. 145/D215/12/008
 in the area named
SEAFORD HEIGHTS
PRELIMINARY
 CT .../....

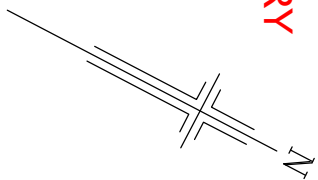

- LEGEND**
- WATER METER
 - SEWER IP
 - STOBIE POLE
 - TELSTRA PIT
 - S/W GRATING
 - SEWER MAN HOLE
 - S/W MANHOLE
 - LIGHT POLE
 - ETSA CONNECTION
 - TAP
 - BOLLARD
 - SIGN
 - S/W CONNECTION
 - FOOTPATH
 - SIDE ENTRY PIT
 - COMMON SERVICE TRENCH
 - DOMESTIC
 - SEWER IO
 - POTABLE WATER CONN
 - NON-POTABLE WATER CONN
 - TOP RETAINING WALL

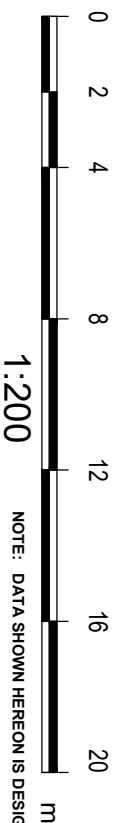

DISCLAIMER:
 Please note that this site plan is intended for visual purposes only, additional survey work will be required prior to commencing any design or construction on the site.

IMPORTANT
 SERVICE AND DRIVEWAY LOCATIONS ARE APPROXIMATE. ANY CHANGES WILL BE AT THE PURCHASERS EXPENSE.
 PURCHASER: _____
 PURCHASER: _____
 DATE: _____

ALLOTMENT 561 in DEV. NO. 145/D215/12/008
 in the area named
SEAFORD HEIGHTS
 CT .../.../...

PRELIMINARY

COTTERELL ROAD

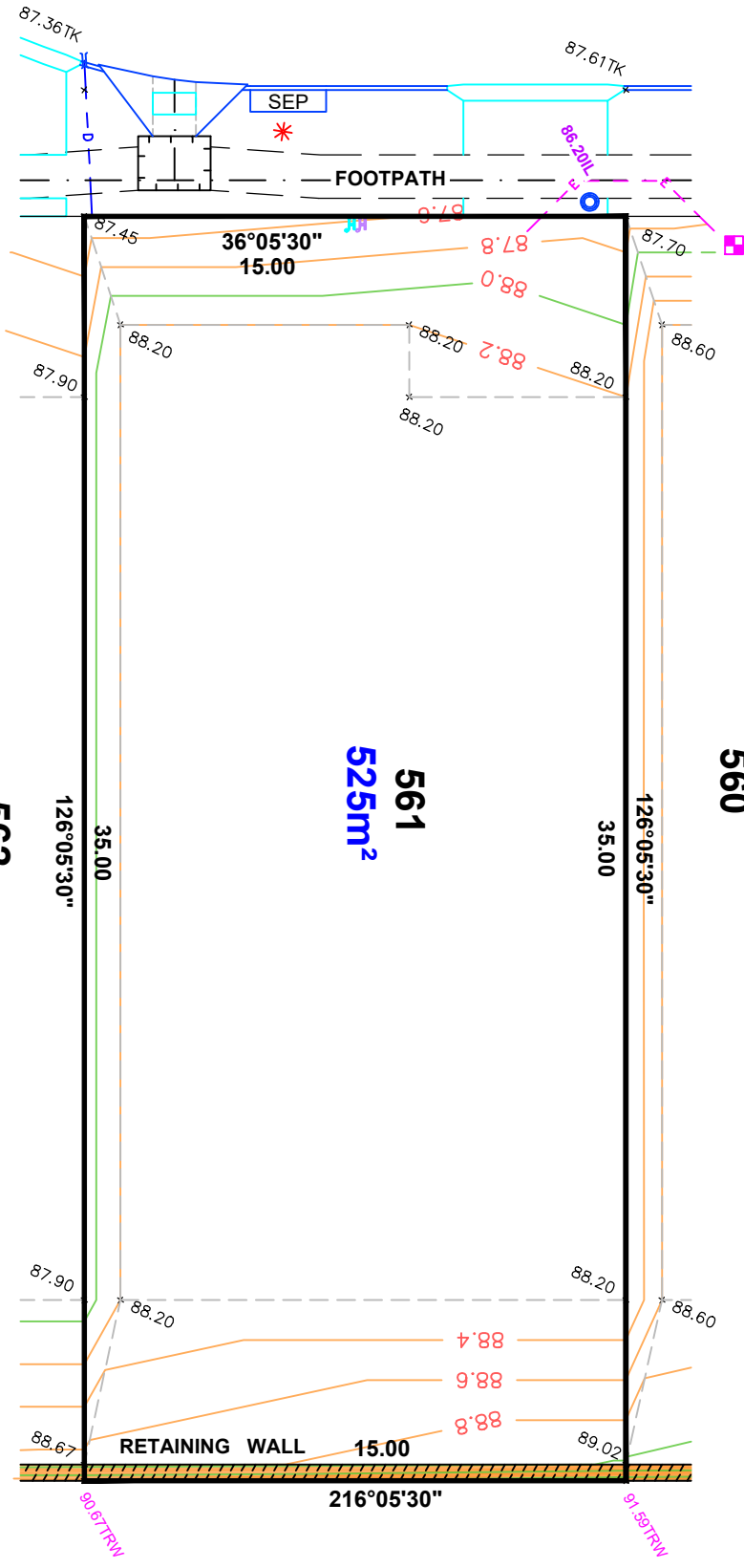

- LEGEND**
- Water Meter
 - Sewer IP
 - Stobie Pole
 - Telstra Pole
 - S/W Grating
 - Sewer Man Hole
 - S/W Manhole
 - Light Pole
 - ETSA Connection
 - Tap
 - Bollard
 - Sign
 - S/W Connection
 - Footpath
 - Side Entry Pit
 - Common Service Trench
 - Domestic
 - Sewer IO
 - Potable Water Conn
 - Non-Potable Water Conn
 - Top Retaining Wall



1:200

NOTE: DATA SHOWN HEREON IS DESIGN INFORMATION AND SHOULD BE CONFIRMED

ORIGINAL SHEET SIZE A4

DISCLAIMER:
 Please note that this site plan is intended for visual purposes only, additional survey work will be required prior to commencing any design or construction on the site.

IMPORTANT
 SERVICE AND DRIVEWAY LOCATIONS ARE APPROXIMATE. ANY CHANGES WILL BE AT THE PURCHASERS EXPENSE.
 PURCHASER: _____
 PURCHASER: _____
 DATE: _____

COTTERELL ROAD

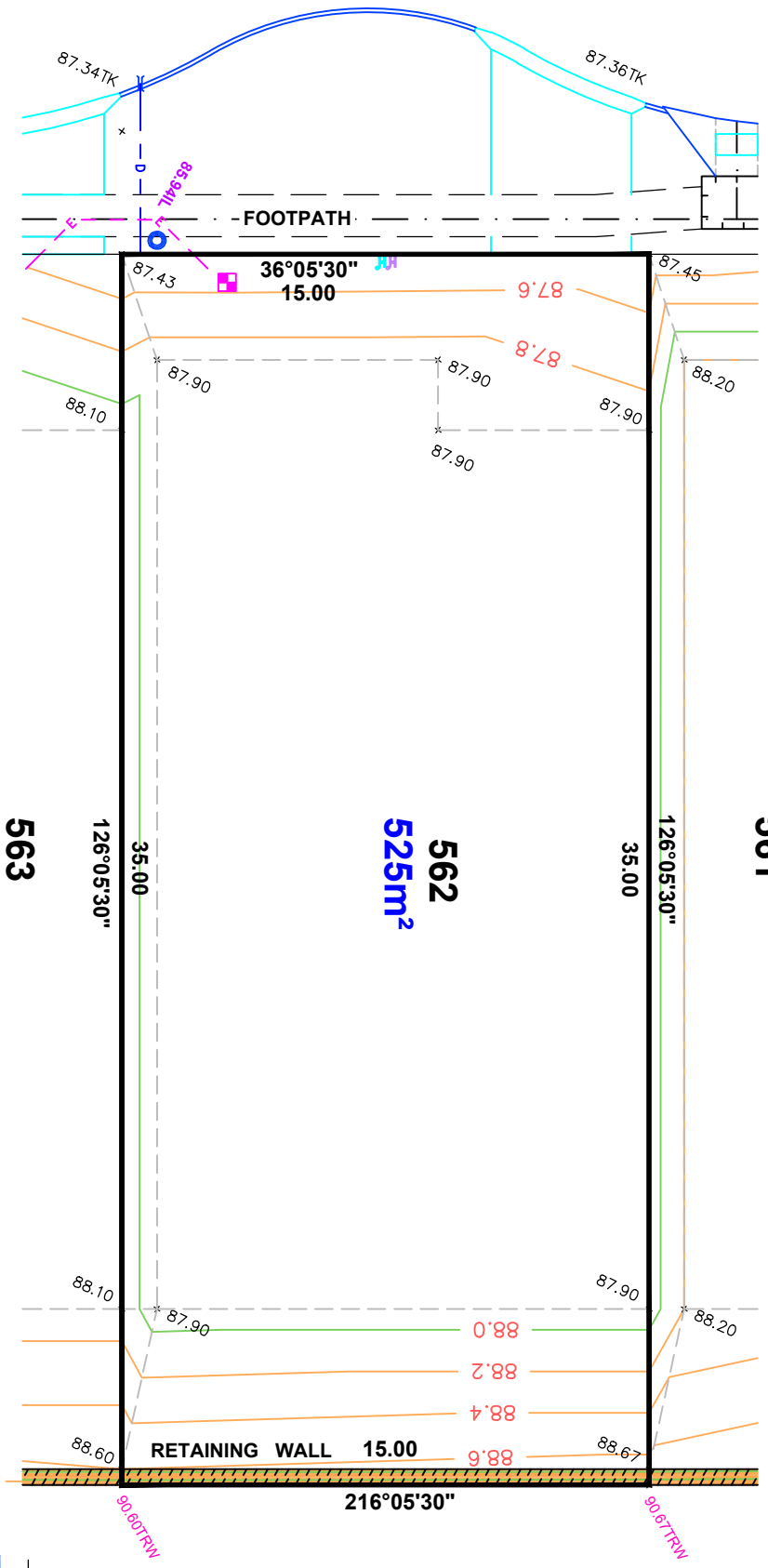

ALLOTMENT 562 in DEV. NO. 145/D215/12/008
 in the area named
SEAFORD HEIGHTS
PRELIMINARY
 CT ---/---

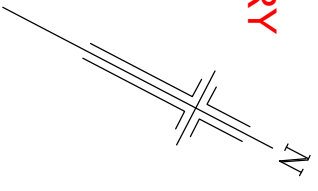

- LEGEND**
- WATER METER
 - SEWER IP
 - STOBIE POLE
 - TELSTRA PIT
 - S/W GRATING
 - SEWER MAN HOLE
 - S/W MANHOLE
 - LIGHT POLE
 - ETSA CONNECTION
 - TAP
 - BOLLARD
 - SIGN
 - S/W CONNECTION
 - FOOTPATH
 - SIDE ENTRY PIT
 - COMMON SERVICE TRENCH
 - DOMESTIC
 - SEWER IO
 - POTABLE WATER CONN
 - NON-POTABLE WATER CONN
 - TOP RETAINING WALL



DISCLAIMER:
 Please note that this site plan is intended for visual purposes only, additional survey work will be required prior to commencing any design or construction on the site.

IMPORTANT
 SERVICE AND DRIVEWAY LOCATIONS ARE APPROXIMATE. ANY CHANGES WILL BE AT THE PURCHASERS EXPENSE.
 PURCHASER: _____
 PURCHASER: _____
 DATE: _____

ALLOTMENT 563 in DEV. NO. 145/D215/12/008
 in the area named
SEAFORD HEIGHTS
 CT ---/---

PRELIMINARY

COTTERELL ROAD

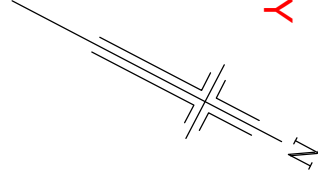
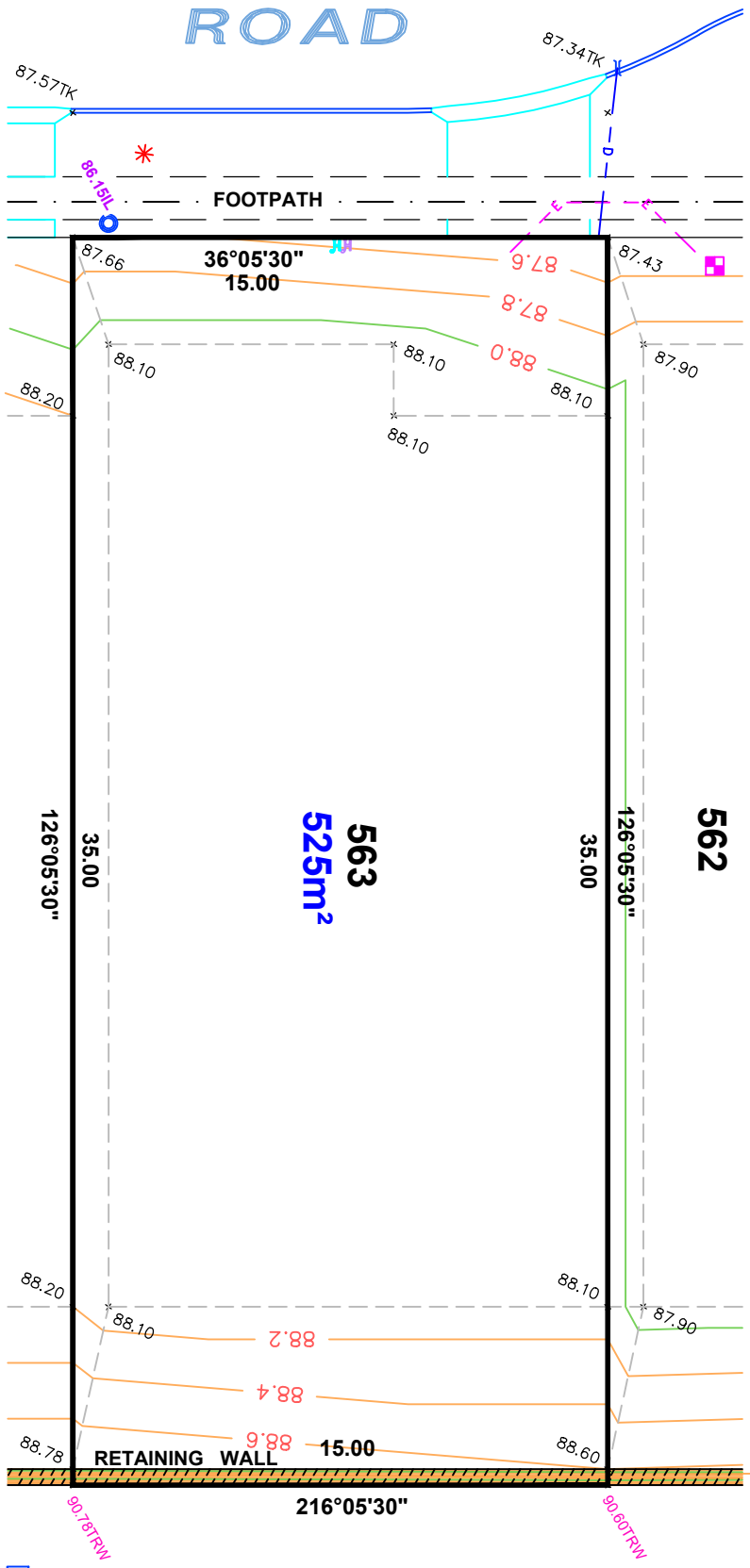

- LEGEND**
- WATER METER
 - SEWER IP
 - STOBIE POLE
 - TELSTRA PIT
 - S/W GRATING
 - SEWER MAN HOLE
 - S/W MANHOLE
 - LIGHT POLE
 - ETSA CONNECTION
 - TAP
 - BOLLARD
 - SIGN
 - S/W CONNECTION
 - FOOTPATH
 - SIDE ENTRY PIT
 - COMMON SERVICE TRENCH
 - DOMESTIC
 - SEWER IO
 - POTABLE WATER CONN
 - NON-POTABLE WATER CONN
 - TOP RETAINING WALL

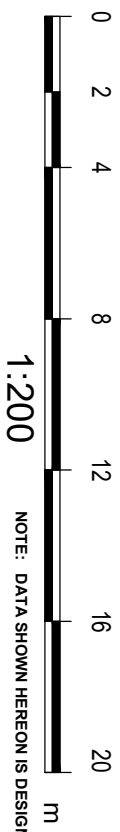

DISCLAIMER:
 Please note that this site plan is intended for visual purposes only, additional survey work will be required prior to commencing any design or construction on the site.

IMPORTANT
 SERVICE AND DRIVEWAY LOCATIONS ARE APPROXIMATE. ANY CHANGES WILL BE AT THE PURCHASERS EXPENSE.
 PURCHASER: _____
 PURCHASER: _____
 DATE: _____

ALLOTMENT 564 in DEV. NO. 145/D215/12/008
 in the area named
SEAFORD HEIGHTS
 CT ---/---

PRELIMINARY

COTTERELL ROAD

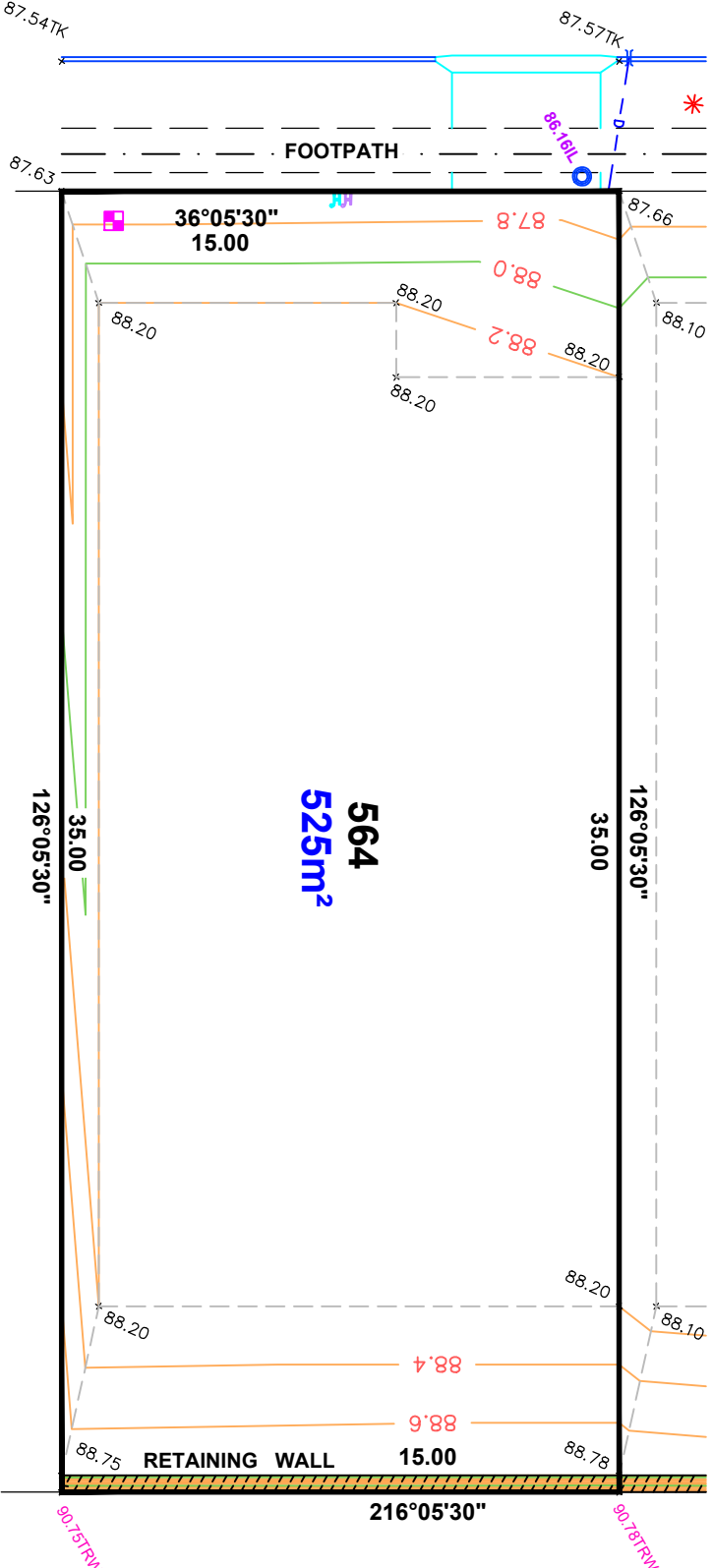

564
525m²

563

602

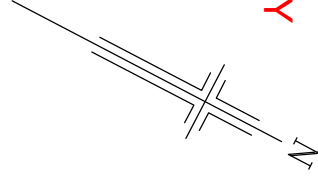

LEGEND

- WATER METER
- SEWER IP
- STOBIE POLE
- TELSTRA PIT
- S/W GRATING
- SEWER MAN HOLE
- S/W MANHOLE
- LIGHT POLE
- Etsa CONNECTION
- TAP
- BOLLARD
- SIGN
- S/W CONNECTION
- FOOTPATH
- SIDE ENTRY PIT
- COMMON SERVICE TRENCH
- DOMESTIC
- SEWER IO
- POTABLE WATER CONN
- NON-POTABLE WATER CONN
- TOP RETAINING WALL

DISCLAIMER:
 Please note that this site plan is intended for visual purposes only, additional survey work will be required prior to commencing any design or construction on the site.



NOTE: DATA SHOWN HEREON IS DESIGN INFORMATION AND SHOULD BE CONFIRMED

DISCLAIMER:

Please note that this site plan is intended for visual purposes only, additional survey work will be required prior to commencing any design or construction on the site.

ALLOTMENT 566 in DEV. NO. 145/D215/12/011

**in the area named
SEAFORD HEIGHTS**

CT ---/----

AS CONSTRUCTED

EVERTON ROAD

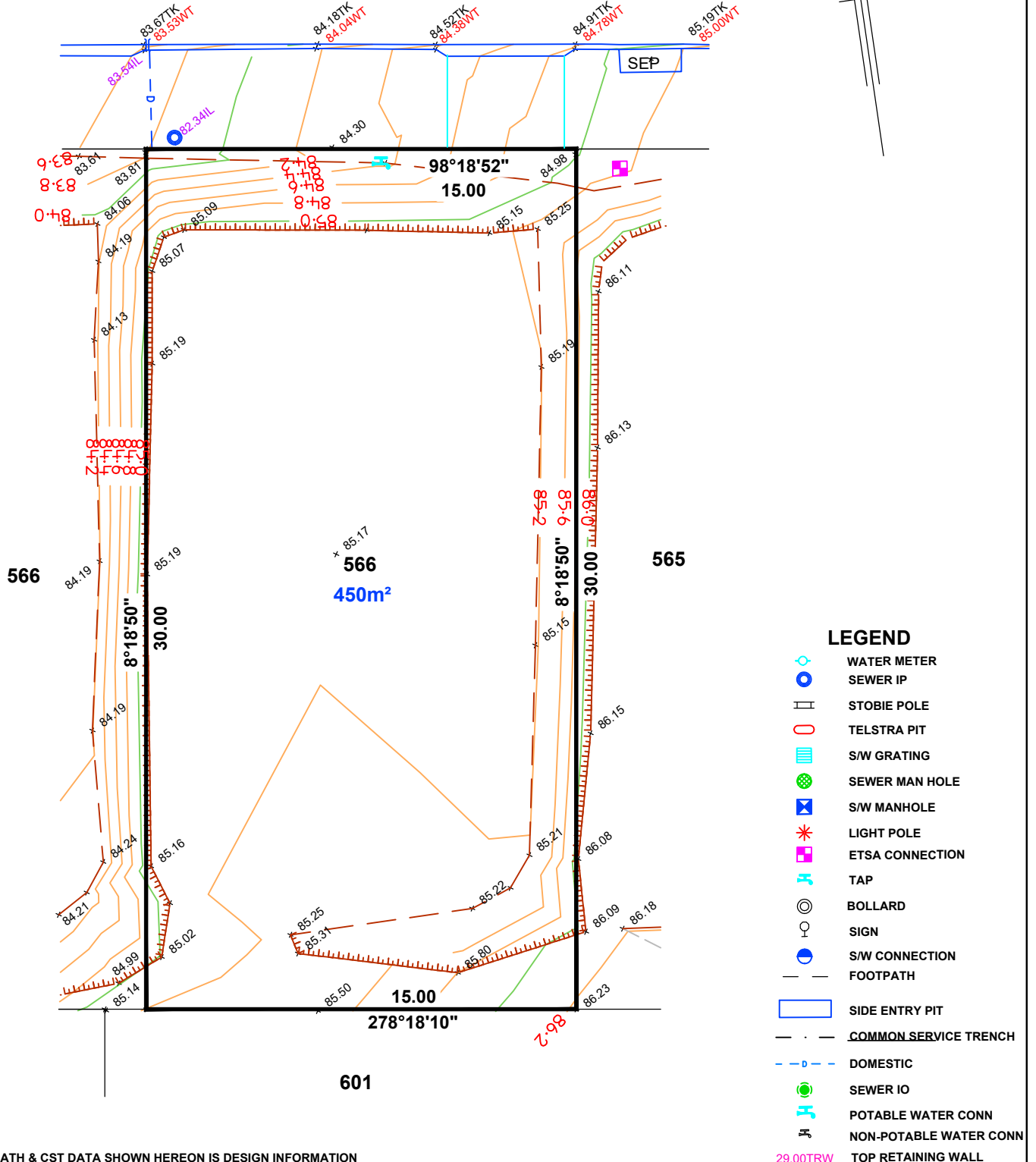

NOTE: FOOTPATH & CST DATA SHOWN HEREON IS DESIGN INFORMATION AND SHOULD BE CONFIRMED.



1:200

ALEXANDER SYMONDS
PH 8130 1666

ORIGINAL SHEET SIZE A4

DISCLAIMER:

Please note that this site plan is intended for visual purposes only, additional survey work will be required prior to commencing any design or construction on the site.

ALLOTMENT 567 in DEV. NO. 145/D215/12/011

**in the area named
SEAFORD HEIGHTS**

CT ---/----

AS CONSTRUCTED

EVERTON ROAD

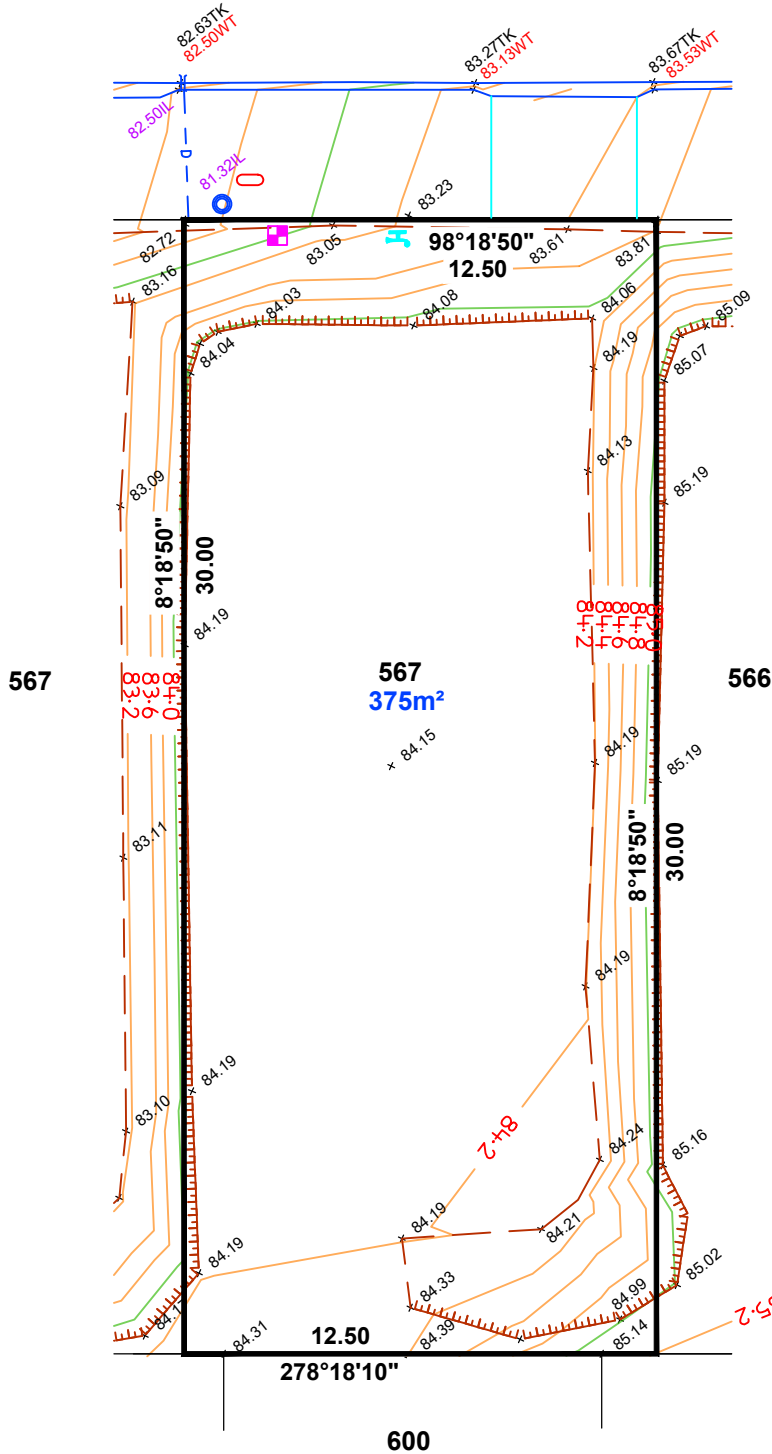

LEGEND

- WATER METER
- SEWER IP
- STOBIE POLE
- TELSTRA PIT
- S/W GRATING
- SEWER MAN HOLE
- S/W MANHOLE
- LIGHT POLE
- ETSA CONNECTION
- TAP
- BOLLARD
- SIGN
- S/W CONNECTION
- FOOTPATH
- SIDE ENTRY PIT
- COMMON SERVICE TRENCH
- DOMESTIC
- SEWER IO
- POTABLE WATER CONN
- NON-POTABLE WATER CONN
- TOP RETAINING WALL

NOTE: FOOTPATH & CST DATA SHOWN HEREON IS DESIGN INFORMATION AND SHOULD BE CONFIRMED.



1:200

ALEXANDER SYMONDS
PH 8130 1666

ORIGINAL SHEET SIZE A4

DISCLAIMER:

Please note that this site plan is intended for visual purposes only, additional survey work will be required prior to commencing any design or construction on the site.

ALLOTMENT 568 in DEV. NO. 145/D215/12/011

**in the area named
SEAFORD HEIGHTS**

CT ---/----

AS CONSTRUCTED

EVERTON ROAD

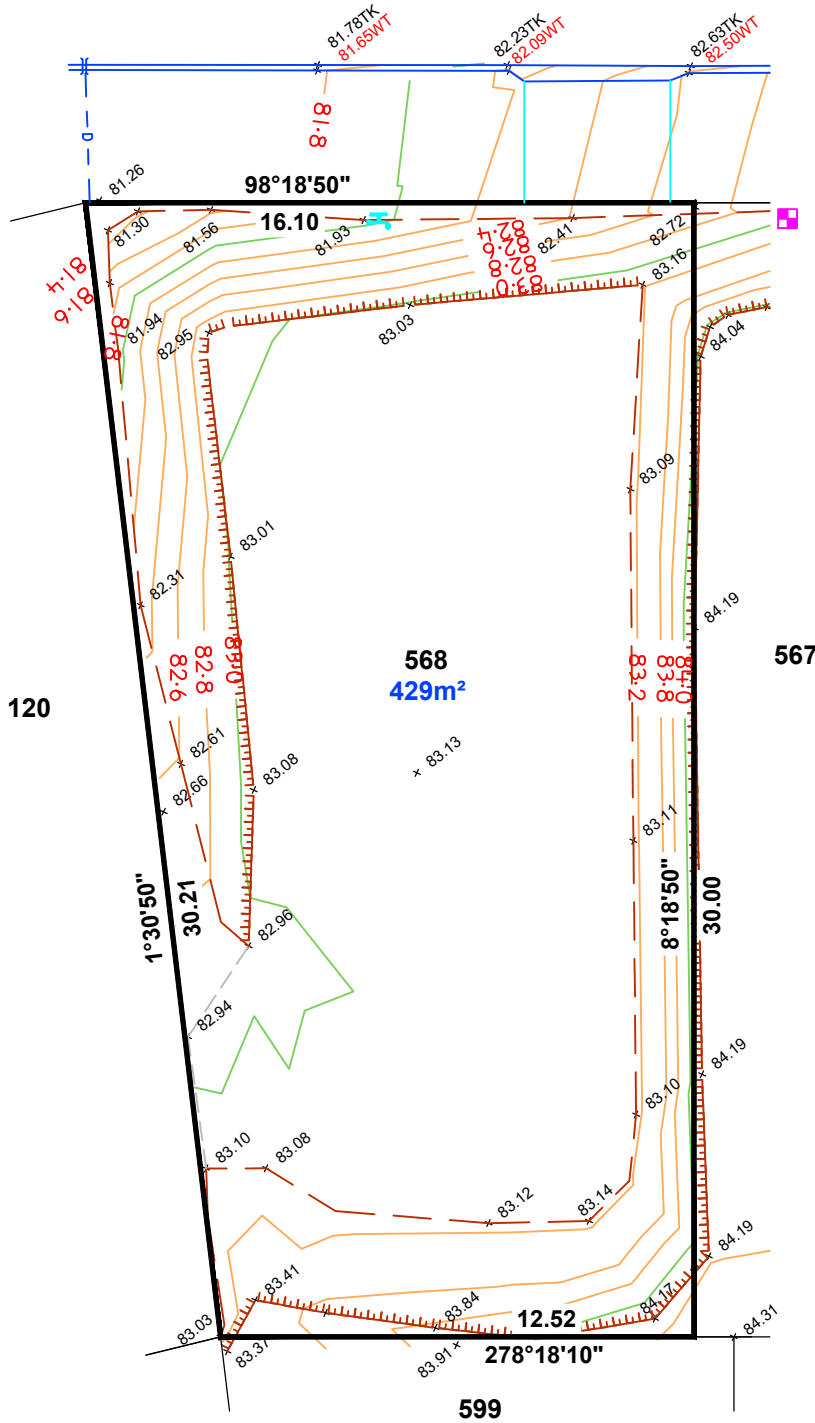
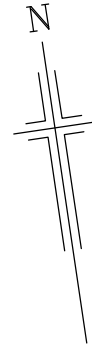

LEGEND

- WATER METER
- SEWER IP
- STOBIE POLE
- TELSTRA PIT
- S/W GRATING
- SEWER MAN HOLE
- S/W MANHOLE
- LIGHT POLE
- ETSA CONNECTION
- TAP
- BOLLARD
- SIGN
- S/W CONNECTION
- FOOTPATH
- SIDE ENTRY PIT
- COMMON SERVICE TRENCH
- DOMESTIC
- SEWER IO
- POTABLE WATER CONN
- NON-POTABLE WATER CONN
- TOP RETAINING WALL

NOTE: FOOTPATH & CST DATA SHOWN HEREON IS DESIGN INFORMATION AND SHOULD BE CONFIRMED.



1:200

ALEXANDER SYMONDS
PH 8130 1666

ORIGINAL SHEET SIZE A4